

1		
Description	Material	Finish
Body	Brass	Gold
Pin	Brass	Gold
Insulation	Teflon	Teflon
Lock Washer	BE CU	Gold
Crimp Ring	Brass	Gold

SIDE VIEW

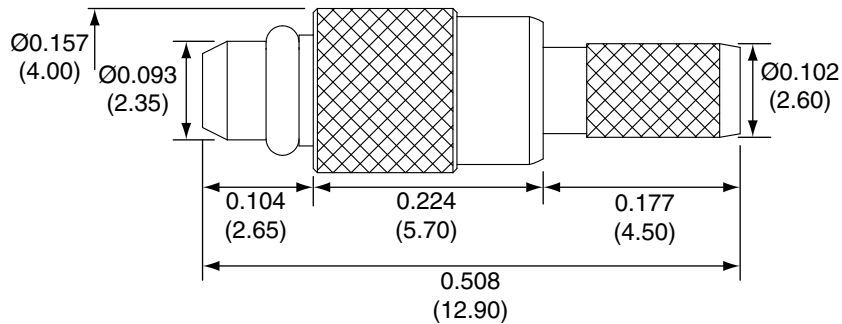

PIN

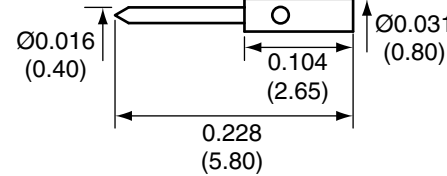

CRIMP RING

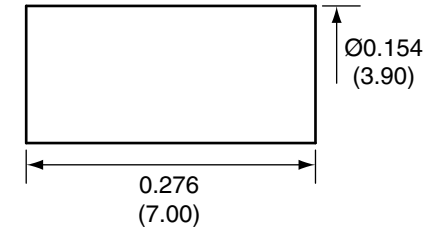

RECOMMENDED CABLE STRIPPING DIMENSIONS

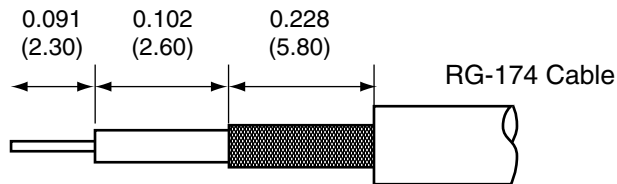

CONMMCX007 ASSEMBLY INSTRUCTIONS

1. Solder the pin to the center conductor.
2. Insert the pin, center conductor, and insulator into the body until the top of the pin is even with the body.
3. Wrap the braid around the tail of the body and crimp the ring with a 0.137" hex crimp tool (or one labeled for use with RG-174 cable).

Title MMCX MALE CABLE END CRIMP FOR RG174 CABLE		CONNECTOR CITY 159 ORT LANE MERLIN, OR 97532 PH (541)-471-6256 FAX (541)-471-6251	
Part No.	CONMMCX007	Revision:	1.0
Dimensions:	INCHES (mm)	Date:	6/14/2006
		Sheet 1 of 1	

CONNECTOR CITY
THE VALUE OF CONNECTIONS